

| 公差/General tolerances(mm) | | 公差/General tolerances(mm) | |
|---------------------------|-------|---------------------------|-------|
| 0 | >3 | >6 | >10 |
| ~ | ~ | ~ | ~ |
| 3 | 6 | 10 | 18 |
| ±0.12 | ±0.18 | ±0.22 | ±0.28 |
| ±0.31 | ±0.37 | ±0.57 | ±0.80 |
| ±0.93 | ±1.05 | ±1.15 | ±1.60 |
| ±2.20 | ±2.50 | | |
| 0.1/1.0 | | | |
| ±2° | | | |

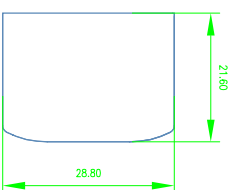
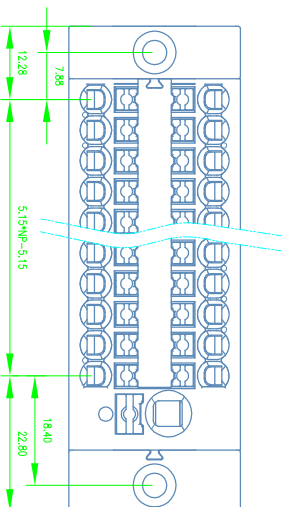
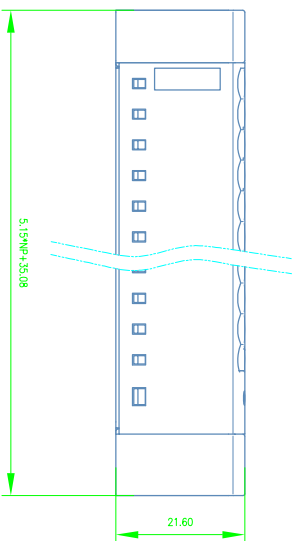
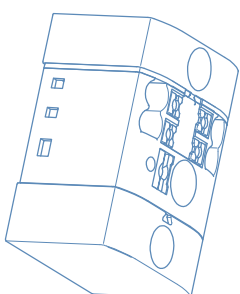
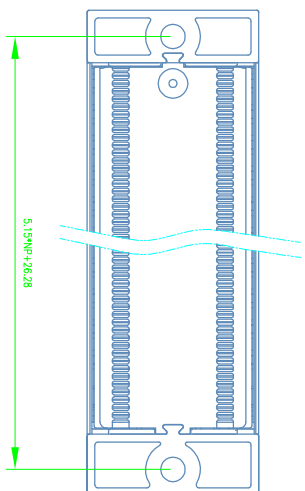

| | | | |
|------|--------------|----------|-----------|
| 4 | 薄片 | 301 不锈钢 | / |
| 3 | 联线件 | 紫铜 | Sn Plated |
| 2 | 按钮 | PA66 | UL94V-0 |
| 1 | 壳体 | PA66 | UL94V-0 |
| ITEM | NAME OF PART | MATERIAL | NOTES |

| | | | |
|-----------------------------------------------------------|------------------|--------|--------|
| UL 标准/UL Standard: | B | C | D |
| 额定电压/电涌/Rated Voltage(V)/Current(A) | 690/24 | / | 690/24 |
| EC 标准/IEC Standard: | | | |
| 过压类别/Overvoltage Category/污染等级/Pollution Degree | III/3 | III/2 | II/2 |
| 额定电压/电涌/Rated Voltage(V)/Current(A) | / | 690/41 | / |
| 额定脉冲电压(kV)/Rate Impulse Voltage(kV) | / | 4 | / |
| 线径范围/线径、主线/Range of Wire Diameter/Wire Diameter/Lead Wire | 0.2-4 / 0.5-6/10 | | |
| 间距/Pitch(mm)/线数范围/Poles | 5.15/N=02~12P | | |
| 剥线长度/Stripping length(mm) | 8-10 | | |
| 使用温度范围/Operating temperature(°C) | -40~+105 | | |
| 符合RoHS环保要求/Conform to RoHS | Yes | | |

MATERIAL: / SURFACE: /

MAT NO.: /

STATUS: /

APPD: 2023.04.08 NAME: **KANGWEI 康伟电子有限公司** KANGWEI WEIELECTRONICS CO.,LTD

CHKD: 2023.04.08

DRFT: 2023.8.03 DRAWING NO.: KV225A-5.15

TYPE: CUSTOMER_DRAWING SCALE: 2:1 SHEET 1/1

REV ECN DESCRIPTION DRFT DATE

1 2 3 4 5 6